

# FUCINEFILM

Welcome to FUCINE FILM S.P.A.

Should you have any question concerning your safety, please do not hesitate to ask your host or Responsible Care

## GUIDE FOR SAFETY AND COMPLIANCE WITH HACCP / BRC STANDARDS FOR VISITORS AND EXTERNAL COMPANIES

- FUCINE FILM S.P.A. is committed to providing a safe healthy environment for all its employees and all persons entering the company.
- Beware to moving or in transit vehicles when walking in the external areas.
- Everyone inside the production area must stay on designed walkways, path and gangways paying attention to vehicles, machinery and hanged loads and when going up or down the stairs hold handrails.
- The **FUCINE FILM S.P.A.** is committed to ensuring the highest degree of hygiene of its products; for this purpose, it has established a regulation based on the HACCP, BRC / IOP rules and that visitors are required to respect. Access to the production areas is not allowed to those affected by infectious and transmissible diseases such as Typhus, Paratyphus, Salmonella, Cholera, Hepatitis A.
- Before going to the production areas, visitors are required to wear the intended uniform and to wash and / or sanitize their hands. In the production areas it is forbidden to wear watches, necklaces, bracelets, earrings, rings (except for the smooth ones), other jewels, false nails and nail varnishes. In case of lost contact lenses or breakage of glasses, the accompanying personnel must be notified immediately.
- Inside the production areas it is forbidden to eat (even chewing gum), drink and smoke, it is also forbidden to bring food and personal items such as bags, cases, bottles, etc. with the exception of notepads, agendas and non-separable pens.
- In the production areas the use of lubricants, knives, blades, ceramic glass and rigid plastics is regulated, the need for use must therefore be previously communicated and agreed.

**No one is allowed to enter the company without authorization and must always be accompanied by personnel (unless specifically authorized).**

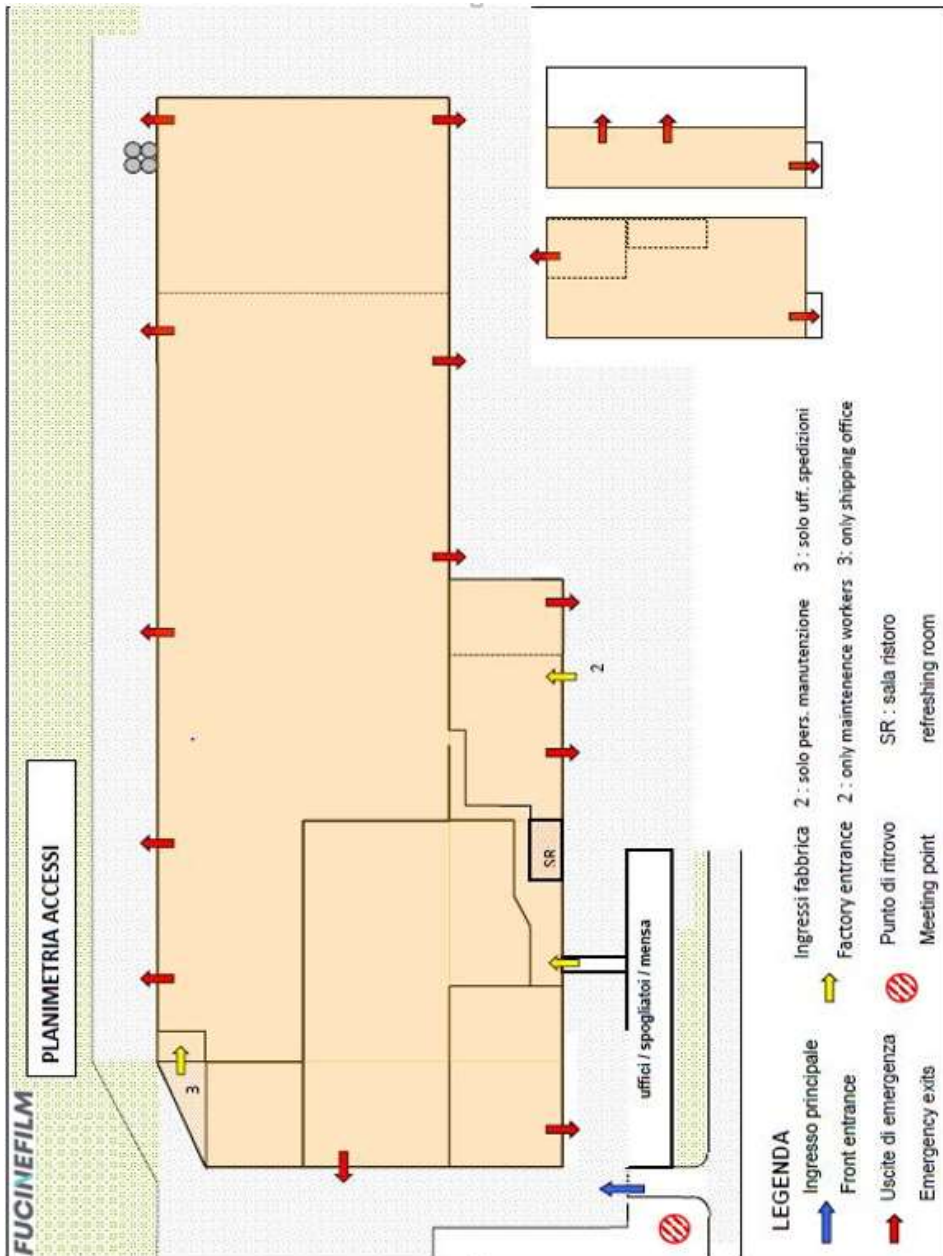

## RISKS FOR SAFETY AND HEALTH

### Fire and explosion

The fire risk was assessed as a medium entity. In every area of the establishment it is forbidden to smoke or use open flames and to use plants or equipment for welding and grinding without the permission of the Plant Manager. Particularly at risk areas are highlighted:

- warehouse
- solvent deposit
- thermal central

### Noise

The surveys have shown that the level of exposure to environmental noise is above 80 dB (A) and below 85 dB (A).

### Accidents due to the circulation of mobile vehicles

Inside the factory there are usually mobile vehicles (forklifts and electric pallet trucks), so pedestrians must pay attention to the mobile vehicles and drivers must proceed at a walking pace (at most 10 km / h) in the external areas.

#### In particular, it requires:

- Respect all signs
- Do not stand in areas that may give rise to hazards or obstructions due to the circulation of other vehicles
- Do not keep the engine running during stops

### Personal protective equipment

All workers of external companies must enter the company with the personal protective equipment necessary for the work of their activity.

**THE VISITOR OR PERSONNEL OF EXTERNAL UNDERTAKINGS CAN REMAIN IN PLACE ONLY IF ACCOMPANIED BY AN AUTHORIZED OR EXPRESSLY AUTHORIZED**

## EXTERNAL EMERGENCY NUMBER

UNIQUE NUMBER OF EMERGENCY	<b>112</b>
----------------------------	------------

## OBLIGATIONS, PROHIBITIONS, REQUIREMENTS

IT IS OBLIGATORY TO RESPECT THE EXTERNAL AND INTERNAL SIGNS TO THE FACTORY

IT IS STRICTLY FORBIDDEN TO FALL THE STREETS OF ESCAPE, EMERGENCY EXITS AND ALL ACCESS TO FIRE-FIGHTING MEANS

DO NOT USE ANY EQUIPMENT OF **FUCINE FILM S.P.A.** WITHOUT EXPRESS AUTHORIZATION



IN ALL THE PLANT YOU ARE OBSERVING THE **BAN TO SMOKE AND USE FREE FLAMES**



VIETATO DI ACCESSO  
ALLE PERSONE  
NON AUTORIZZATE

RESPECT THE **PROHIBITION OF ACCESS** TO THE VARIOUS LOCAL INTERDECTS



**DO NOT TAKE FOOD AND DRINKS** EXCEPT IN PLACED PLACES (SHELTERS, AREAS WHERE AUTOMATIC FOOD AND DRINK DISTRIBUTORS ARE PRESENT)



GUANTI DI PROTEZIONE  
OBBLIGATORIE



CALZATURE DI SICUREZZA  
OBBLIGATORIE



PROTEZIONE  
OBBLIGATORIA  
DELLE VIE  
RESPIRATORIE

WEAR THE PERSONAL PROTECTIONS IF REPORTED OR NECESSARY TO YOUR OWN ACTIVITY



WASH HANDS

## EMERGENCY PROCEDURE OF EXTERNAL COMPANIES, VISITORS

INTRODUCTION: TO APPLY THIS PROCEDURE IT IS NECESSARY TO HAVE READ THE PLANS SHOWN TO IDENTIFY THE NEAREST EXODUS PATHS AND THE MEETING PLACE (ANTISTANT AREA THE MAIN ENTRANCE OF THE ESTABLISHMENT) AFTER THE EVACUATION.

### WHOEVER REMAINS AN EMERGENCY SITUATION:

- Fire
- Explosion
- Gas leaks
- Earthquake
- Lack of electricity
- Any other abnormal or dangerous situation
- Injury or illness

#### 1. **WARNING THE PERSONNEL FUCINE FILM S.P.A**

#### 2. **LEAVING LOCALS AND REACHING THE SECURE PLACE OF SAFE WHERE THE EXTERNAL AID OR THE EMERGENCY COORDINATOR IS WAITING**

#### 3. **TO THE ALARM SIGNAL (DATED BY OTHERS) IT IS NECESSARY TO ABANDON THE PLANT FOLLOWING THE STREETS OF FUGA AND TO RECEIVE IN THE PLACE OF MEETING**

#### 4. **IN CASE OF INJURY OR HEALTH IS PRESENT THE PERSONNEL TRAINED FOR THE FIRST AID, WHICH MAY BE ADVERTISED THROUGH THE OFFICE PHONE.**

## DURING EVACUATION, TAKE THE FOLLOWING CAUTIONS

### In case of fire

DO NOT CLOSE DOORS KEY; if there is smoke, walk on all fours or head down; open the doors with extreme caution. Before opening a door, touch it up to feel if it is hot. If it is hot or if there is a smoke spill, look for another escape route or open, if there are no alternatives, with extreme caution, sheltering behind the door to avoid flames;

### In the event of an explosion

Carefully evacuate the affected department avoiding to use open flames of any kind and keeping away from windows, glass, objects that may fall;

### In case of gas leaks

Do not use open flames, ventilate the premises by opening the windows, do not switch on or off the light or other electrical equipment, avoid access to rooms already filled with fumes or vapors;

### In the event of an earthquake:

Keep away from shelving, windows, glass, objects that may fall.

### REMEMBER:

- The shortest route to choose and a possible alternative route must already be clear.
- Do not leave the meeting place before the appeal has been made by those present and before the order of the COORDINATOR.

Signature: \_\_\_\_\_